

# CITY TOWER

BROOKLYN

## RESIDENCE P

FLOORS 29-38

2 BEDROOMS | 2 BATHROOMS

## HOME INTERIORS

### APARTMENT

5" WOOD PLANK FLOORING  
WASHER/DRYER  
VERTICAL HEATING / COOLING  
FLOOR TO CEILING WINDOWS  
CUSTOM SOLAR SHADES  
DOUBLE HUNG  
WIC  
IN-CLOSET SHELVING

### KITCHEN

WHITE QUARTZ COUNTER TOPS  
PANELIZED APPLIANCES  
BUILT-IN COOKTOP AND CONVECTION OVEN  
UNDER-CABINET LIGHTING  
TRACK LIGHTING

### BATHROOM

WHITE QUARTZ COUNTER TOPS  
TAUPE LINEN PORCELAIN FLOORING  
MOSAIC TILE FEATURE WALL  
KOHLER FIXTURES  
CUSTOM SHELVING STORAGE

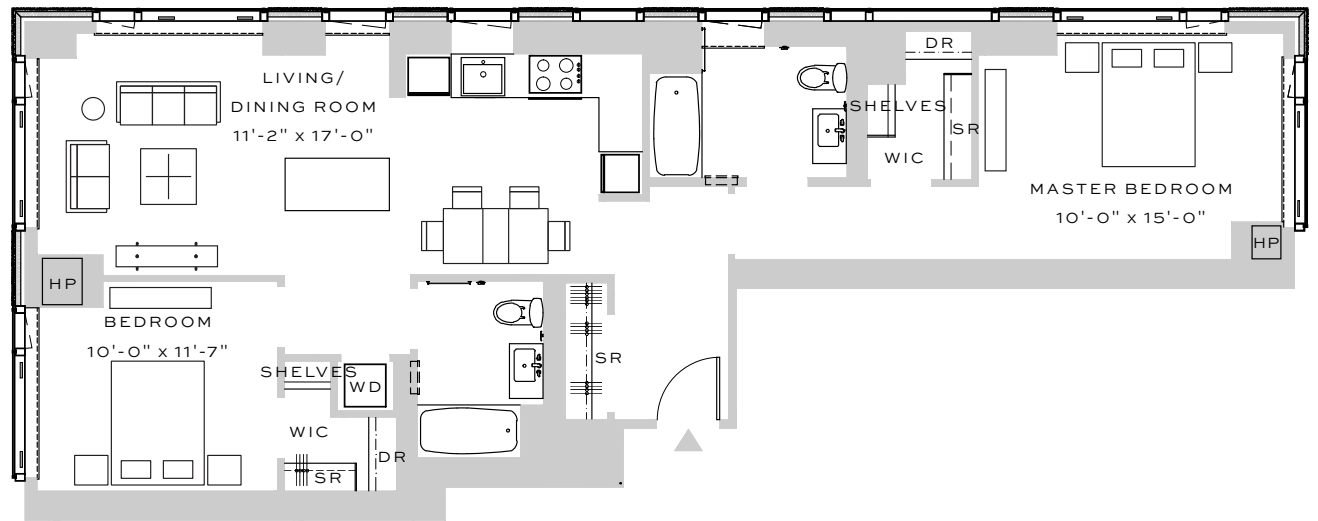

DATE

RENT / UNIT

AGENT



ALL INFORMATION REGARDING THE FLOOR PLAN IS FROM SOURCES DEEMED RELIABLE. HOWEVER, THE BRODSKY ORGANIZATION CANNOT ASSURE ITS ACCURACY AND BEARS NO RESPONSIBILITY FOR ANY ERRORS, OMISSIONS OR MISSTATEMENTS. THE PLAN IS FOR APPROXIMATE INFORMATIONAL PURPOSES ONLY AND SHOULD BE USED AS SUCH BY THE PROSPECTIVE RENTER. ALL DIMENSIONS ARE APPROXIMATE AND SHOULD BE RE-MEASURED BY THE PROSPECTIVE RENTER FOR ABSOLUTE ACCURACY.

7 NORTH

