

CITY TOWER

BROOKLYN

RESIDENCE C
FLOORS 20-42
STUDIO | 1 BATHROOM

HOME INTERIORS

APARTMENT
5" WOOD PLANK FLOORING
WASHER/DRYER
HORIZONTAL HEATING / COOLING
CUSTOM SOLAR SHADES
DOUBLE HUNG
WIC
IN-CLOSET SHELVING

KITCHEN
WHITE QUARTZ COUNTER TOPS
PANELIZED APPLIANCES
BUILT-IN COOKTOP AND CONVECTION OVEN
UNDER-CABINET LIGHTING
TRACK LIGHTING
PANTRY

BATHROOM
WHITE QUARTZ COUNTER TOPS
TAUPE LINEN PORCELAIN FLOORING
MOSAIC TILE FEATURE WALL
KOHLER FIXTURES
CUSTOM SHELVING STORAGE

DATE _____

RENT / UNIT _____

AGENT _____

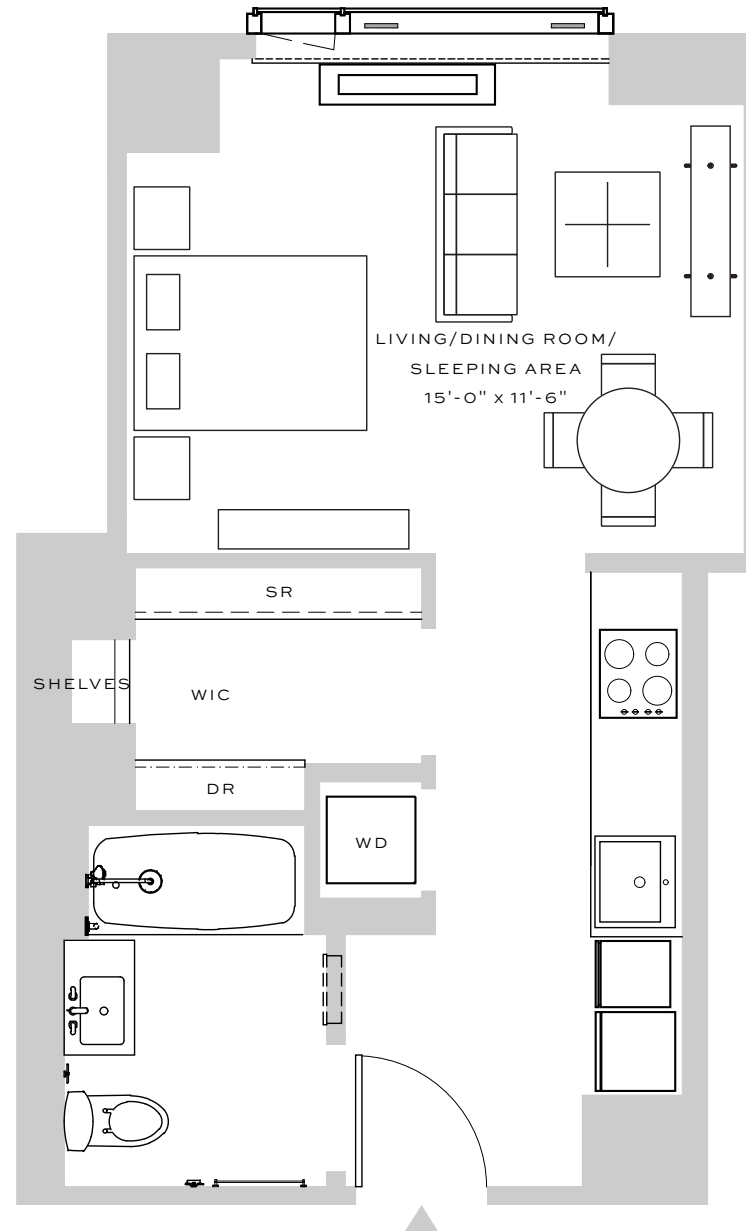

ALL INFORMATION REGARDING THE FLOOR PLAN IS FROM SOURCES DEEMED RELIABLE. HOWEVER, THE BRODSKY ORGANIZATION CANNOT ASSURE ITS ACCURACY AND BEARS NO RESPONSIBILITY FOR ANY ERRORS, OMISSIONS OR MISSTATEMENTS. THE PLAN IS FOR APPROXIMATE INFORMATIONAL PURPOSES ONLY AND SHOULD BE USED AS SUCH BY THE PROSPECTIVE RENTER. ALL DIMENSIONS ARE APPROXIMATE AND SHOULD BE RE-MEASURED BY THE PROSPECTIVE RENTER FOR ABSOLUTE ACCURACY.

▲ NORTH

0'

6'

12'